

PRESQUE ISLE COUNTY RECYCLING

Presque Isle Conservation District
658 S Bradley Hwy | Rogers City, MI 49779

989-734-4000
PresqueIsleRecycling.org



PresqueIsleRecycling.org | 989-734-4000

Local
Postal Customer

PRSR STD
ECRWSS
U.S. POSTAGE
PAID
EDDM RETAIL

BIN LOCATIONS Where to Recycle

ALL SITES AVAILABLE TO ANY PRESQUE ISLE COUNTY RESIDENT

These bin locations are open 24/7, except as noted.

- 1 Allis Township Hall**
20018 W 638 Hwy , Onaway
In the parking lot
- 2 Hawks**
8097 Co Rd 451
In parking lot next to the Post Office
- 3 Krakow Transfer Station**
13936 US 23 S, Presque Isle
Year-round
Wed 1-4 pm
Sat 10am-4 pm
Plus Memorial Day thru Labor Day Weekends
Sun 10am-2pm
- 4 Millersburg**
5280 Walker Hwy
West end of the Fire Hall parking lot
- 5 North Allis Township Hall**
1940 M-211, Onaway
In the parking lot
- 6 Ocqueoc Transfer Station**
6900 N Ocqueoc Rd
0.6 miles south of US 23 N
May thru Sept
Mon, Wed, Sat 9am-5pm
Oct thru April
Wed & Sat 9am-5pm
- 7 Posen Village Hall**
1703 E State St (E 634 Hwy)
In the parking lot
- 8 Presque Isle Township Hall**
12653 E Grand Lake Hwy
In the parking lot
- 9 Rogers City Transfer Station**
503 Park Dr, Rogers City



PRESQUE ISLE COUNTY Recycling Guide

THANK YOU FOR SUPPORTING THE MILLAGE!

EMPTY & RECYCLE

Plastic bottles and containers

Cartons and cups

Cans and foil

Cardboard

Papers

BAGGED Bread and grocery bags

BAG YOUR BAGS

Containers

- Plastic bottles, jugs and jars
- Plastic tubs, trays and cups (no straws)
- Juice boxes, milk cartons and paper cups
- Metal cans, foil and trays
- Glass bottles and jars (no breakables)

EmmetRecycling.org

Paper, Boxes and Bags

- Newspapers and inserts
- Magazines, catalogs and books
- Office and writing paper
- Cardboard, cereal boxes and grocery bags (no frozen)
- Plastic grocery & bread bags (clean, dry, heaped)

EmmetRecycling.org

NO Non-container plastic, metal or glass

NO Styrofoam

NO Sharps



Sort your recycling into two groups:

CONTAINERS go into one bin

EMPTY & RECYCLE

Juice boxes, milk cartons and paper cups

- NO juice pouches or straws

Plastic bottles, jugs and jars, tubs, trays and cups

- Any 2.5 gallons or less
- Yes, plastic caps and lids, on their container, are now recyclable.
- NO Styrofoam
- **PUT BAGGED PLASTIC BAGS IN THE PAPER BIN**

Metal cans, foil and trays, aluminum, steel and tin

- Metal lids, too
- NO aerosol cans or propane tanks

Glass bottles and jars

- All colors and clear
- NO light bulbs, window glass, or glass dishes

NO Non-container plastic, metal or glass

NO Styrofoam

NO Sharps

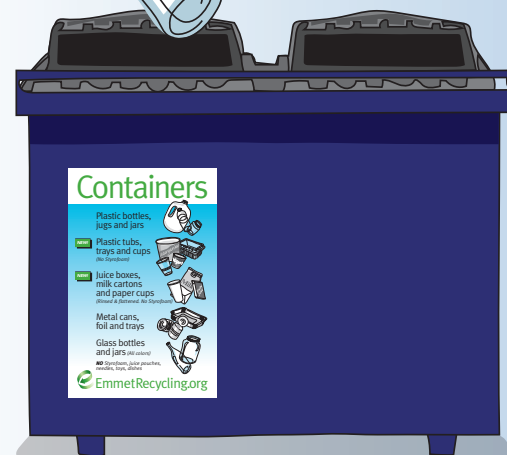
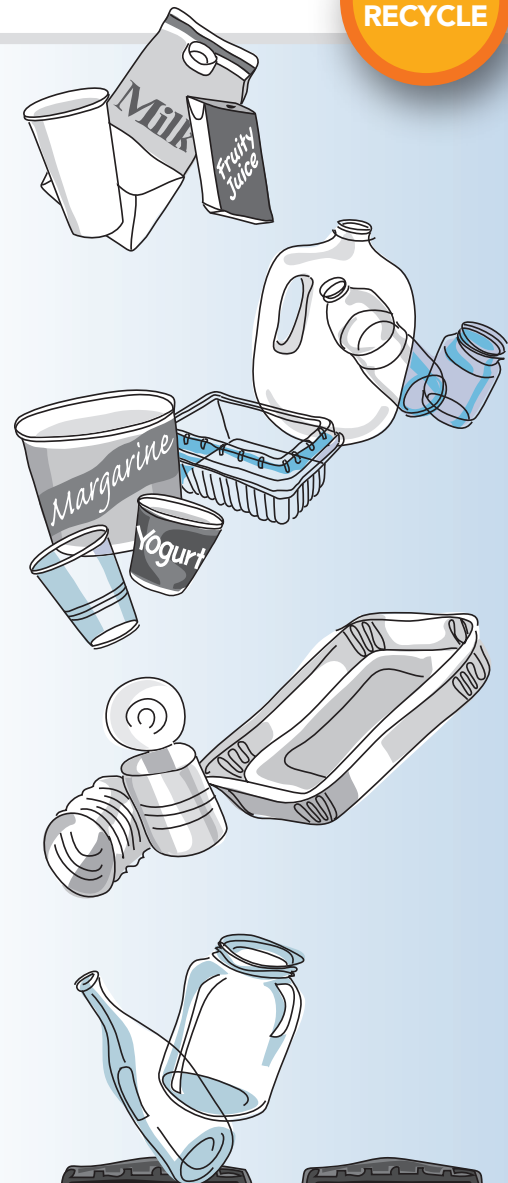
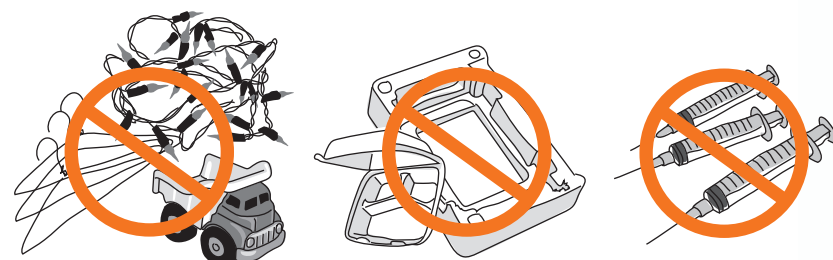

PAPER, BOXES AND BAGS go into another bin

Cardboard and paper bags

- Also okay to include: boxes from frozen and refrigerated foods; boxboard — like cereal boxes and paper towel cores
- Please flatten boxes
- NO Styrofoam

Newspapers, magazines, catalogs and books

- All okay: hardcover, paperback and phone books

Office paper

- Also okay to include: envelopes and file folders and shredded paper. Please contain shredded paper in a plastic grocery bag.

Plastic grocery and bread bags

- **STRETCHY, CLEAN AND DRY ONLY!**
- **BAG YOUR BAGS — stuff all your plastic bags into one bag and tie it shut.**
- Also okay to include: case wrap (as used on multipacks of water bottles, paper towel rolls), bubble wrap, plastic envelopes
- NO "crunchy" plastic film, i.e. chip/pretzel bags, cellophane



BAG YOUR BAGS



Still not sure if it's recyclable?

Visit us at www.PresqueIsleRecycling.org or call 989-734-4000